

Your ref
Our ref
Ask for Christine Lewis
Email Christine.lewis@lichfielddc.gov.uk



District Council House, Frog Lane
Lichfield, Staffordshire WS136YU

Customer Services 01543 308000
Direct Line 01543 308072

3 April 2017

Dear Sir/Madam

REGULATORY AND LICENSING COMMITTEE

A meeting of the above mentioned Committee has been arranged to take place on **Tuesday 11th APRIL 2017 at 5.30 p.m.** in the **Training Room**, District Council House, Lichfield to consider the following business.

Yours faithfully

A handwritten signature in black ink, appearing to read 'Neil Turner', is shown on a light grey background.

Neil Turner BSc (Hons) MSc
Director of Transformation & Resources

To: **Members of Regulatory and Licensing Committee:**

Councillors B Yeates (Chairman), Warfield (Vice Chairman), Mrs Baker, Mrs Barnett, Drinkwater, Mrs Eagland, Mrs Evans, Miss Fisher, Humphreys, Leytham, O'Hagan, Miss Shepherd, Smedley, Mrs Stanhope MBE, A. Yeates.



www.lichfielddc.gov.uk



[/lichfielddc](https://www.facebook.com/lichfielddc)



[lichfield_dc](https://twitter.com/lichfield_dc)



MyStaffs App

AGENDA

1. Apologies for Absence
2. Declarations of Interest
3. Proposed Diversion of Part of Public Bridleway No 31 in The Parish Of Fradley with Streethay (copy attached)



PROPOSED DIVERSION OF PART OF PUBLIC FOOTPATH NO.31 IN THE PARISH OF FRADLEY WITH STREETHAY



Date: 11 APRIL 2017
Agenda Item: Item 3
Contact Officer: Carol Pepper
Tel Number: 01543 308072
Email: carol.pepper@lichfielddc.gov.uk
Key Decision? NO
Local Ward Member: Cllrs. Mrs Margaret Stanhope MBE, Ben Rayner and Mike Wilcox

REGULATORY & LICENSING COMMITTEE

1. Executive Summary

- 1.1 To ask Members to consider an application received from Prologis Developments Ltd for a proposed diversion of part of Public Footpath No.31 in the Parish of Fradley with Streethay.

2. Recommendations

- 2.1 It is recommended that part of Public Footpath No. 31 is diverted around the periphery of the site, and adjustments are made to part of the south westerly part of the footpath to maintain integrity of the network.

3. Background

- 3.1 In November 2009 the Regulatory and Licensing Committee granted permission to Prologis Development Ltd to divert the original footpath 31 to avoid it crossing the proposed development site.
- 3.2 In June 2016 the route of Public Footpath No.31 was confirmed.
- 3.3 In October 2016 two alternative Reserved Matters proposals were granted giving two alternative routes for the footpath, these routes raise conflicts with users of the footpath and HGV's/cars entering the development. The developers now seek permission to divert the route around the periphery of the development. (See attached Map **Appendix A**)
- 3.4 The proposed route of the footpath is shown as a red broken line running from point A, to B, to C, to D.
- 3.5 The section of the footpath shown as a bold red line running from point A to D will be extinguished.
- 3.6 The part of the route from point D to E, to F, to G, to H, shown as a broken black line will remain unchanged.
- 3.7 The County Council noticed a discrepancy in the mapping of Footpath 31 in June 2016 and permission is also sought to correct this by extending the footpath from point H to point J shown as a broken blue line and extinguishing that part of the footpath from point J to point K shown as a bold blue line to remove the cul-de-sac effect at this point.

Alternative Options

1. Leave the Footpath as it is with users crossing through the site rather than walking round the edge.

	2. Leave the Footpath as it is and the integrity of the network will be incorrect and confusing to users.
Consultation	1. With Local Organisations including the Ramblers, Peak and Northern, Open Spaces Society, Staffordshire County Council, Fradley with Streethay Parish Council, British Horse Society, S Staffordshire Water Plc., Central Networks, Byways & Bridleways Trust, Plant Protection Team – National Grid, Auto Cycle Union and Ward Councillors.
Financial Implications	1. No financial implications for the Council have been identified. 2. Administrative and advertisement cost will be incurred in the making of the Public Footpath Order, but these will be met by the Applicant
Contribution to the Delivery of the Strategic Plan	1. None identified.
Equality, Diversity and Human Rights Implications	1. None identified.
Crime & Safety Issues	1. Not applicable.

	Risk Description	How We Manage It	Severity of Risk (RYG)
A	None identified.		State if risk is Red (severe), Yellow (material) or Green (tolerable) as determined by the Likelihood and Impact Assessment.
B			
C			
D			
E			

Background documents
Appendix A – Map of Proposed Diversion

Relevant web links

APP. A

Proposed Diversion of Public Footpath No. 31 (part) Fradley and Streethay Parish.

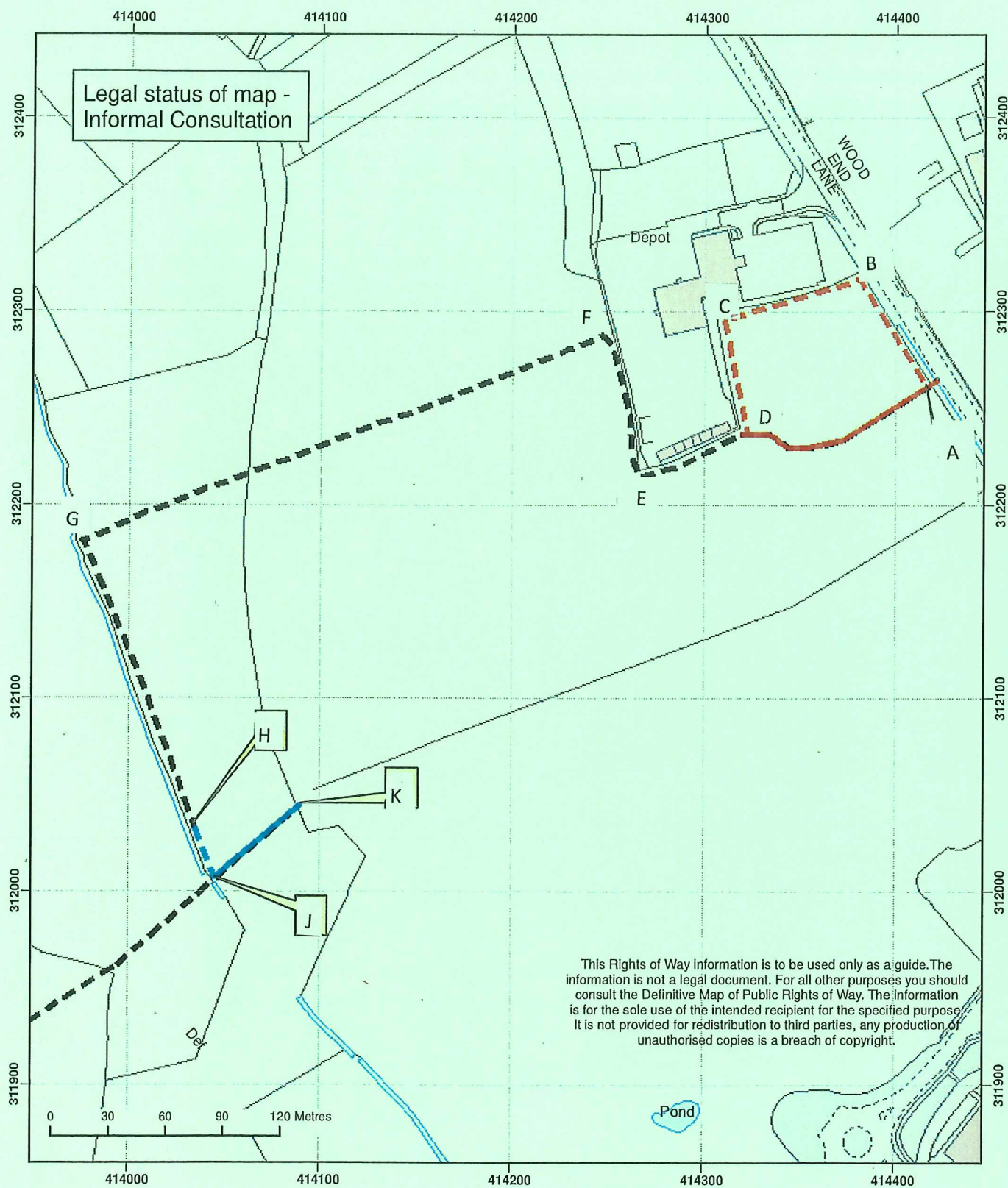

Map created at the scale of 1:2750
(facsimiles may vary)

© Crown Copyright and database rights 2017.
Ordnance Survey 100019422. You are not
permitted to copy, sub-license, distribute or
sell any of this data to third parties in any form.
Use of this data is subject to the terms and conditions
shown at www.staffordshire.gov.uk/maps.
Produced by Staffordshire County Council, 06/03/2017.

- Current route of right of way.
- - - Proposed Delta Planning diversion.
- Proposed Delta Planning diversion (existing route).
- - - Right of Way required to maintain network integrity.
- Right of Way deletion required to remove cul-de-sac path.